

# Flip-Ease™

DRY TO WET

## USER'S GUIDE 5288 SERIES 220-240V



3 Safety Instructions

4 Product View

5 Assembly

5-7 Operations

7-8 Maintenance and Care

9 Troubleshooting

10 Consumer Services

11 Replacement Parts

12 Warranty



## Thanks for buying a BISSELL Flip-Ease™ Cordless Hard Floor Cleaner

We're glad you purchased a BISSELL Flip-Ease. Everything we know about floor care went into the design and construction of this complete, convenient cleaning system.

Your BISSELL Flip-Ease is well made, and we back it with a limited one-year warranty. We also stand behind it with a knowledgeable, dedicated Consumer Services department, so, should you ever have a problem, you'll receive fast, considerate assistance.

My great-grandfather invented the floor sweeper in 1876. Today, BISSELL is a global leader in the design, manufacture, and service of high quality homecare products like your BISSELL Flip-Ease.

Thanks again, from all of us at BISSELL.

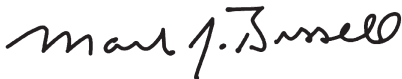

**Mark J. Bissell**  
President and Chief Executive Officer

# IMPORTANT SAFETY INSTRUCTIONS

When using an electrical appliance, basic precautions should be observed, including the following:

**READ ALL INSTRUCTIONS BEFORE USING YOUR BISSELL FLIP-EASE CORDLESS HARD FLOOR CLEANER.**

## **WARNING -**

**To reduce the risk of fire, electric shock, or injury:**

- Store indoors.
- Do not expose to rain.
- Do not immerse.
- Do not handle with wet hands.
- Do not use Flip-Ease if it has been dropped, damaged, left outdoors or dropped into water. Have it repaired at an Authorized Service Center.
- Do not use with damaged cord or plug on the charger.
- Do not unplug charger by pulling on cord.
- Do not damage the charger cord. Never carry or pull the charger unit by the cord, use cord as a handle, close door on cord, or pull cord around sharp edges or corners. Keep cord away from heated surfaces.
- Do not use an extension cord. Charger should plug directly into electrical outlet.
- Do not put any object into appliance openings, use with blocked opening, or restrict air flow.
- Do not expose hair, loose clothing, fingers or body parts to openings or moving parts.
- Do not pick up hot, burning or smoking objects such as cigarettes, matches or hot ashes.
- Do not pick up flammable or combustible materials (lighter fluid, petrol, kerosene, etc.) or use in the presence of explosive liquids or vapours.
- Do not use appliance in an enclosed space filled with vapours given off by oil base paint, paint thinner, some moth proofing substances, flammable dust, or other explosive or toxic vapours.
- Do not pick up toxic material (chlorine bleach, ammonia, drain cleaner, petrol, etc.).
- Do not allow to be used as a toy.
- Not intended for use by young children or infirm persons without supervision.
- Young children should be supervised to ensure that they do not play with the appliance.

- Do not use for any purpose other than described in this User's Guide.
- Use only manufacturer's recommended attachments - use of attachments not provided or sold by BISSELL may cause fire, electric shock or injury.
- Use only cleaning products formulated or recommended by BISSELL for this appliance.
- Use only the charger supplied by BISSELL (packaged with your appliance) to recharge your Flip-Ease.
- Use charger unit only in standard electrical outlet (220-240V~50/60 Hz.).
- Use charger in dry location only.
- Keep openings free of dust, lint, hair, etc.
- Unplug charger unit from outlet before maintenance or cleaning.
- Unplug by grasping the plug, not the cord.
- Be extra careful when cleaning stairs.
- Turn off all controls when finished cleaning.
- Do not charge the unit outdoors.

Your Flip-Ease contains rechargeable nickel cadmium batteries. Do not incinerate batteries as they can explode when exposed to high temperatures.

Battery cell leaks can occur under extreme conditions. If battery cell liquid comes in contact with the skin:

- Wash immediately with soap and water, then neutralize with a mild acid such as vinegar or lemon juice.
- If battery cell liquid gets into the eyes: Flush immediately with clean water for a minimum of 10 minutes.
- Seek medical attention.

## **SAVE THESE INSTRUCTIONS.**

**IMPORTANT** FOR OPERATION ON A 220-240 VOLT A.C. 50/60 Hz POWER SUPPLY ONLY.

**THIS MODEL IS FOR HOUSEHOLD USE ONLY.**

## Product View

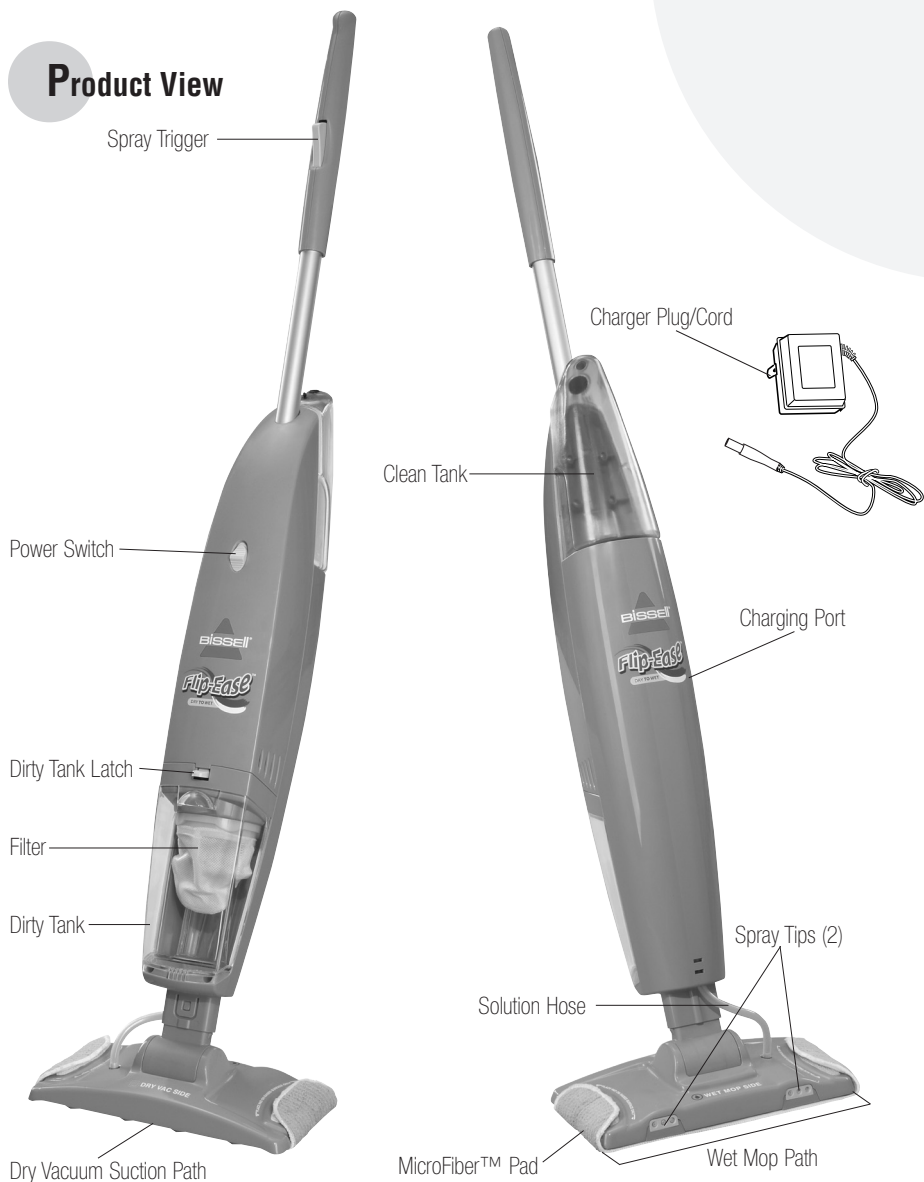

**CAUTION:** Only use BISSELL Hard Floor Solutions in your cleaner. Use of cleaning formulas that contain lemon or pine oil may damage this appliance and void the warranty. Do not use chemical spot cleaners or solvent-based soil removers. These products may react with the plastic materials used in your cleaner, causing cracking or pitting.

## How to use this guide

This user's guide has been designed to help you get the most satisfaction from your Flip-Ease cordless hard floor cleaner. You'll find assembly directions, instructions for all cleaning tasks, safety precautions, plus maintenance and troubleshooting instructions. Please read this user's guide thoroughly before using your Flip-Ease. Pay particular attention to the parts diagram, assembly instructions, and part names. Familiarize yourself with the controls and how they're used. Following this user's guide will greatly enhance your ability to get the best performance from your Flip-Ease for many years.

## Assembly

Assembling your new Flip-Ease is a 3 step process, requiring no tools.

1. Insert foot into body of unit, making sure that the notches are aligned correctly. Push down until you hear a click.
2. Place the solution tube onto the spray connector.
3. Insert the handle into the body of the unit. Turn handle until key in handle falls into position and you hear a "click".

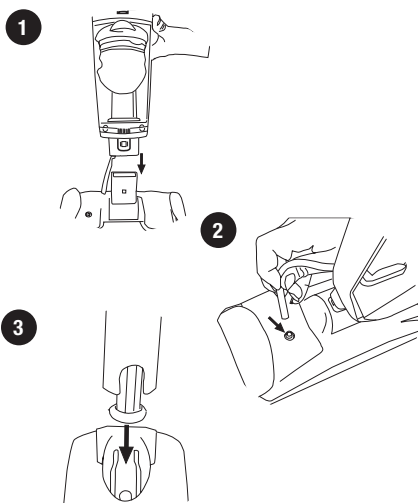

## Operations

### Charging the battery

1. When charging for the first time, allow to charge uninterrupted for at least 12 hours.  
**NOTE: When charging, the Flip-Ease and charger may become warm to the touch. This is normal and no cause for concern.**
2. Power switch must be in "O" (OFF) position to charge.
3. When completely charged, the average run time for dry vacuuming is 12 minutes. When completely discharged, it will take approximately 12 hours to fully recharge.

### *Tip:*

For maximum battery life, completely discharge and recharge Flip-Ease every 1-2 months.

### *Tip:*

After unit is charged (approximately 12 hours) unplug from outlet. This will aid in prolonging the life of the battery.

# Operations (Continued)

## Charging the battery (Continued)

4. To charge your Flip-Ease, connect the round end of the charger cord into the charging port on the side of the unit. Make sure it is securely connected and the charger indicator light is illuminated.

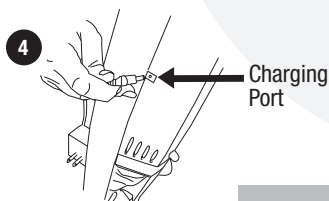

**NOTE: Decreased operating time may indicate that the battery has built up a charging resistance. To recharge, first completely exhaust the battery, recharge it, then exhaust it once again before recharging a second time. This procedure may be required more than once.**

### Tip:

The battery is used only when dry vacuuming. For wet mopping, the battery is not used, extending usage time.

## Filling the clean tank

1. Remove clean tank by grasping it firmly and pulling straight up.
2. Unscrew the black cap on the bottom of the clean tank and remove the insert.
3. Add water and formula\* to the indicated fill lines on the clean tank.  
**\*Note: Your Flip-Ease includes two trial size bottles of formula.**
4. Replace the black cap and insert and place clean tank back on unit.

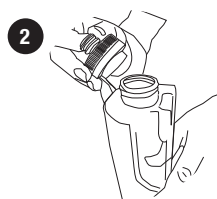

### Tip:

Gently push the tank into place. If you see air bubbles in the tank, it is seated properly.

## Dry vac

1. Attach the MicroFiber pad onto the base of the unit by attaching the pad onto the velcro on one side of the unit, wrapping it under the foot and attaching it to the velcro on the opposite side.  
**Note: If the MicroFiber pad covers the vacuum suction path, the unit will not suction.**

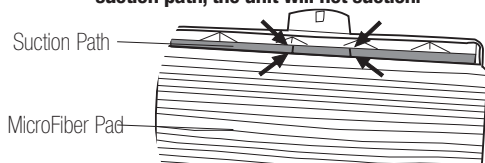

Underside of foot

2. Turn the power switch "I" (ON).
3. With the dry vac side of the unit facing forward, begin cleaning. You will see dry dirt, crumbs and debris being collected in the dirty tank.

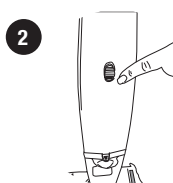
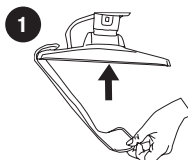

### Tip:

The MicroFiber pad should be placed on the unit as directed. Covering the vacuum suction path will stop all suction.

## Operations (Continued)

4. Check the filter frequently. If you see hair and fuzzy debris collecting on the filter, remove the dirty tank and dirty tank lid to clean the filter.
5. To clean the filter, gently tap it on the edge of the trash can, brushing off anything that may be sticking to the filter. The filter can also be rinsed with warm water. Let air dry before inserting back into the unit.

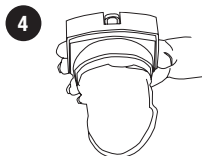

### Switching from dry vac to wet mop

1. To change from dry vacuuming to wet cleaning, simply flip the unit around!

### Wet Mop

1. Depress the spray trigger. Water and formula will flow to the two spray tips on the wet mop side.

**NOTE: Depressing the spray trigger will turn off the vacuum suction.**

2. Gently mop the floor with the MicroFiber pad. Dirty or sticky areas may require more water and formula.
3. Allow 3-5 minutes for the floor to air dry.

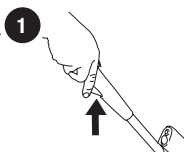

### *Tip:*

When the spray trigger is squeezed the vacuum suction will stop; extending usage time.

### *Tip:*

You do not have to empty the dirty tank before wet mopping.

## Maintenance and care

### Machine care

1. Turn power switch "O" (OFF).
2. After wet mopping is complete, remove the MicroFiber pad from the unit.

**NOTE: Check the clean tank. If a significant amount of water and formula remains, you may leave it in the clean tank for your next cleaning task**

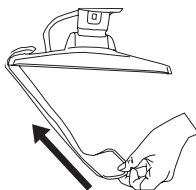

# Maintenance and care (Continued)

## Cleaning the MicroFiber pad

1. To wash the MicroFiber pad, simply toss in the wash, air dry and reuse. No need to buy disposable cloths every time you use your Flip-Ease

## Machine storage

1. Clean exterior surface of Flip-Ease with a soft cloth dampened with water only. Do not use a strong detergent or other cleaners as this may damage the finish.
2. Store Flip-Ease in a protected dry area, at room temperature (40° - 110°F).

## Battery removal and disposal

**Note: The battery must be removed from the Flip-Ease before it is disposed of.**

1. Important: Unplug charger.
2. Remove tanks (clean and dirty) and discard.
3. Remove screws (6) holding product housings together (see diagram).
4. Use a screwdriver to score rating label on side of unit.
5. Separate housings and locate battery pack in bottom/center of unit.

**Note: If the battery is leaking, do not touch it. Contact your local authorities for a safe disposal or recycling facility in your area.**

6. Remove wire connectors from the battery pack.
7. Keep battery packs together – DO NOT separate individual batteries. For proper battery disposal instructions, please contact your local authorities for requirements and regulations on safe disposal or recycling facilities in your area.
8. Discard remainder of product.

## **⚠️ WARNING:**

This product contains a rechargeable nickel cadmium battery (sometimes referred to as a “Ni-Cad” battery) pack. The average life of a Ni-Cad battery is 5 to 7 years, depending on frequency of use. Proper removal and disposal of Ni-Cad batteries is required. Do not dispose of in the municipal waste.

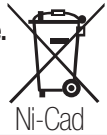

3a

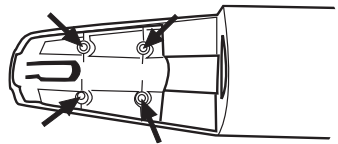

3b

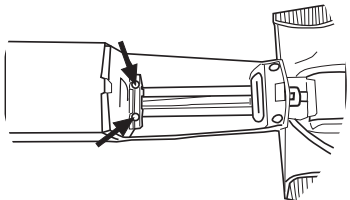



## Troubleshooting



### **WARNING:**

To reduce the risk of electric shock, turn power switch OFF and disconnect charger from electrical outlet before performing maintenance or troubleshooting.

#### **Problems**

1. No suction or unit will not turn on
2. No or low suction
3. No Spray

#### **Possible Causes**

1. Unit is not charged
2. Batteries are run down  
Filter clogged  
Dirty tank not inserted properly  
MicroFiber pad covering suction path  
Clogged suction path  
Foot not properly installed
3. Clean tank is empty  
Clean tank not inserted properly  
Handle not properly inserted  
Solution tube not connected to foot

**Other maintenance or service not included above should be performed by an authorized service representative.**

**Thank you for selecting a BISSELL product.**

**Please do not return this product to the store**

## BISSELL Consumer Services

### If your BISSELL product should require service:

In the UK, Australia or New Zealand, call BISSELL Consumer Services at the numbers below and we will give you the location of a BISSELL Authorized Service Center in your area. For all other countries, contact your local in country distributor for questions, service, or repair.

If you have questions about your warranty or need replacement parts please contact the numbers below.

#### For UK inquiries:

Monday - Thursday 9 am — 5 pm  
Friday 9 am — 4 pm

#### BISSELL Homecare (Overseas) Inc.

The Boat Yard  
105 Straight Road  
Old Windsor  
Berkshire, SL4 2SE  
United Kingdom  
Telephone: 0870-225-0109

#### For New Zealand inquiries:

Monday - Friday 9 am — 5 pm

#### Parex Industries Ltd.

103 Central Park Drive  
Henderson  
Auckland  
New Zealand  
Telephone: 0800-247-735

Or visit the BISSELL website - [www.bissell.com](http://www.bissell.com)

When contacting BISSELL, have model number of unit available.

Please record your Model Number: \_\_\_\_\_

Please record your Purchase Date: \_\_\_\_\_

**Note: Please keep your original sales receipt. It provides proof of date of purchase in the event of a warranty claim. See Warranty on page 12 for details.**

Please do not return this product to the store.

#### For Australian inquiries:

Monday - Friday 9 am — 5 pm

#### BISSELL AUSTRALIA PTY LTD

Unit 35  
15 Ricketts Road  
Mount Waverley, Victoria 3149  
Australia  
Telephone: 1-800-811-183

#### For all other inquiries:

Monday - Friday 8 am — 4 pm

#### BISSELL Homecare, Inc.

PO Box 1888  
Grand Rapids, MI 49501 USA  
Telephone: 01-616-453-4451  
Fax: 01-616-453-1383

# Replacement parts - BISSELL Flip-Ease

Item	Part No.	Part Name
1	203-6917	Handle Assembly
2	203-6918	Clean Tank (w/ Cap & Insert)
3	203-6919	Clean Tank Cap & Insert
4	203-6920	Dirty Tank
5	203-6922	Dirty Tank Lid
6	203-6924	Filter
7	203-6912	MicroFiber Pad
8	203-6949	Charger Plug/Cord – 3 Pin UK Plug
9	203-6950	Charger Plug/Cord – 3 Pin Australian Plug
10	203-6951	Charger Plug/Cord – 2 Pin European Plug
11	0484	32 oz. Hard Floor Solutions

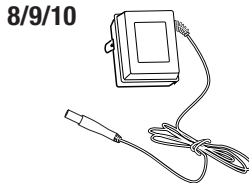
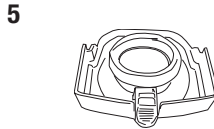
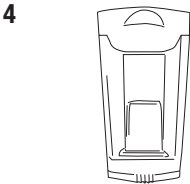
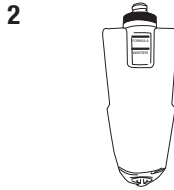
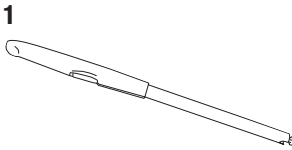

## Warranty - BISSELL Flip-Ease

This warranty gives you specific legal rights, and you may also have other rights which may vary from country to country. If you need additional instruction regarding this warranty or have questions regarding what it may cover, please contact BISSELL Consumer Services by telephone, or regular post as described below, or contact your local in country distributor.

### Limited One Year Warranty

Subject to the \*EXCEPTIONS AND EXCLUSIONS identified below, BISSELL Homecare, Inc., will replace (with new or remanufactured components), at BISSELL's option, free of charge from the date of purchase by the original purchaser, for one year any defective or malfunctioning part do to manufacturers defect.

This warranty applies to product used for personal, and not commercial or rental service. This warranty does not apply to fans or routine maintenance components such as filters, belts, or brushes. Damage or malfunction caused by negligence, abuse, or use not in accordance with the User's Guide is not covered.

#### For UK inquiries:

Monday - Thursday 9 am — 5 pm  
Friday 9 am — 4 pm

#### BISSELL Homecare (Overseas) Inc.

The Boat Yard  
105 Straight Road  
Old Windsor  
Berkshire, SL4 2SE  
United Kingdom  
Telephone: 0870-225-0109

#### For New Zealand inquiries:

Monday - Friday 9 am — 5 pm

#### Parex Industries Ltd.

103 Central Park Drive  
Henderson  
Auckland  
New Zealand  
Telephone: 0800-247-735

#### For Australian inquiries:

Monday - Friday 9 am — 5 pm

#### BISSELL AUSTRALIA PTY LTD

Unit 35  
15 Ricketts Road  
Mount Waverley, Victoria 3149  
Australia  
Telephone: 1-800-811-183

#### For all other inquiries:

Monday - Friday 8 am — 4 pm

#### BISSELL Homecare, Inc.

PO Box 1888  
Grand Rapids, MI 49501 USA  
Telephone: 01-616-453-4451  
Fax: 01-616-453-1383

**BISSELL HOMECARE INC. IS NOT LIABLE FOR INCIDENTAL OR CONSEQUENTIAL DAMAGES OF ANY NATURE ASSOCIATED WITH THE USE OF THIS PRODUCT. BISSELL'S LIABILITY WILL NOT EXCEED THE PURCHASE PRICE OF THE PRODUCT.**

#### \*EXCEPTIONS AND EXCLUSIONS FROM THE TERMS OF THE LIMITED WARRANTY

**THIS WARRANTY IS EXCLUSIVE AND IN LIEU OF ANY OTHER WARRANTIES EITHER ORAL OR WRITTEN. ANY IMPLIED WARRANTIES WHICH MAY ARISE BY OPERATION OF LAW, INCLUDING THE IMPLIED WARRANTIES OF MERCHANTABILITY AND FITNESS FOR A PARTICULAR PURPOSE, ARE LIMITED TO THE ONE YEAR DURATION FROM THE DATE OF PURCHASE AS DESCRIBED ABOVE.**



©2007 BISSELL Homecare, Inc  
Grand Rapids, Michigan  
All rights reserved. Printed in China  
Part Number 120-4019  
Rev 11/07  
Visit our website at:  
[www.bissell.com](http://www.bissell.com)

